

Please rate this document after reviewing at the bottom of this page.

REPLACEMENT

⚠ CAUTION

- Special grease must be applied to the driveshaft joint. Do not substitute with another type of grease.
- The boot band should be replaced with a new one.

1. Remove the Front Driveshaft.
(Refer to Driveshaft Assembly - "Front Driveshaft")
2. Remove the BJ circlip (B) from the TJ housing (A).

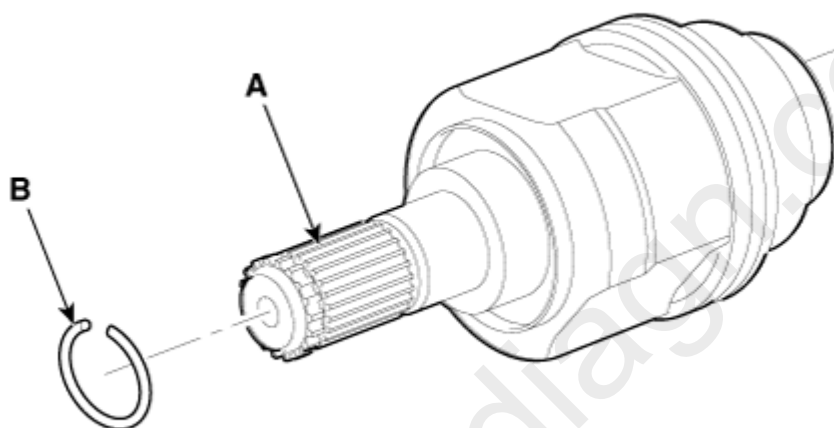

3. Remove both boot bands from the TJ housing.

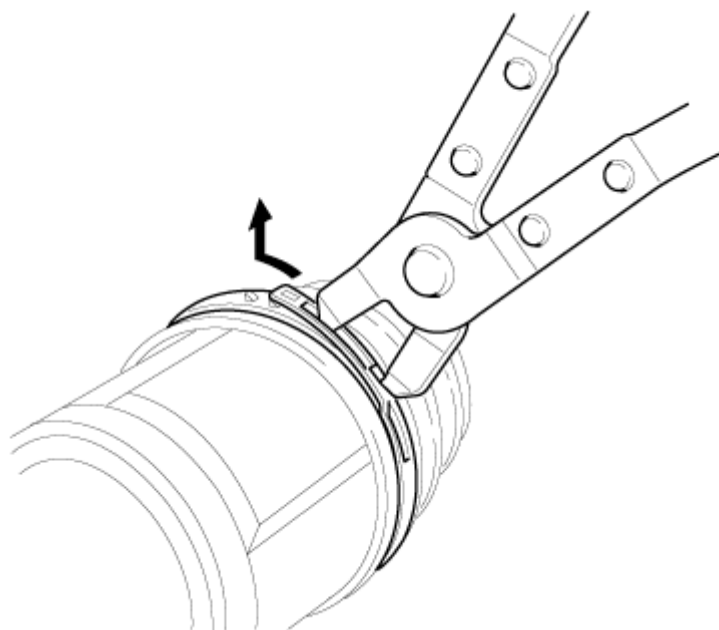

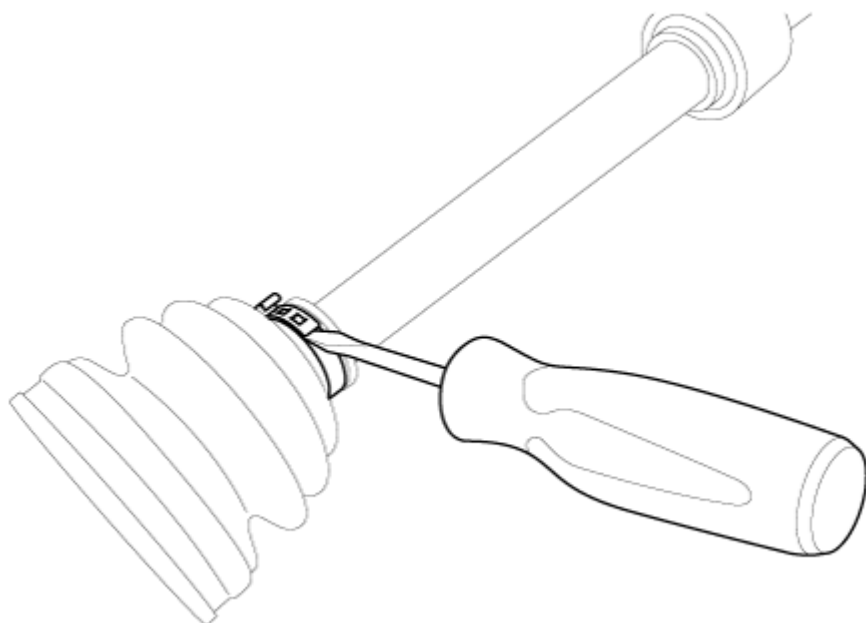

4. Remove the TJ circlip (A).

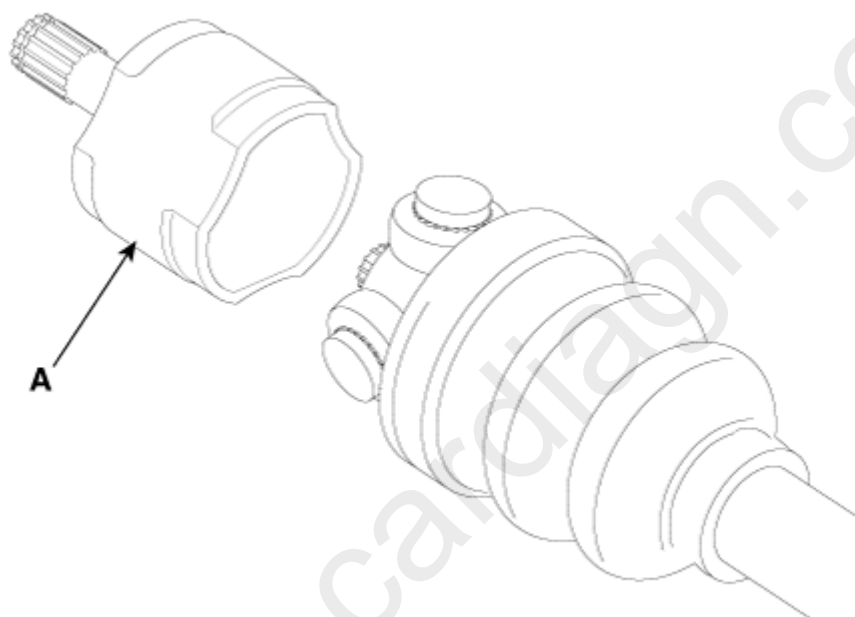

5. Remove the snap ring (A) from the shaft.

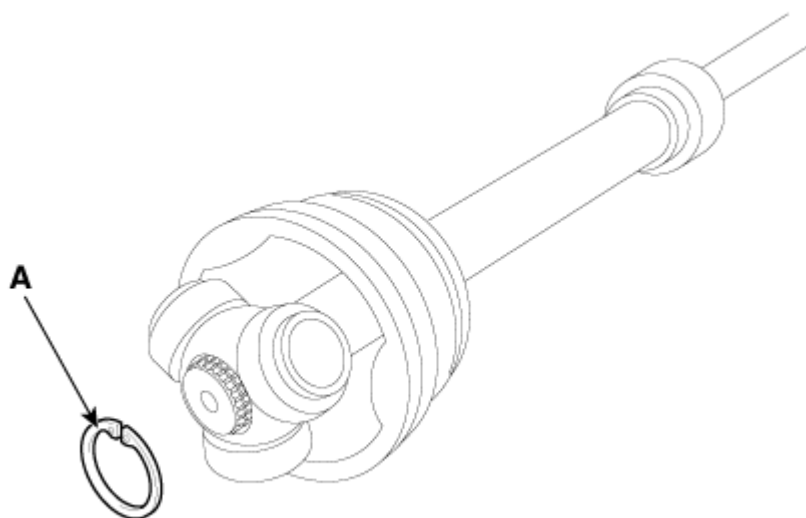

6. Clean the spider assembly.

7. Remove the TJ boot (A).

CAUTION

- For reusing the boot (A), wrap tape (B) around the driveshaft splines (C) to protect the boot (A).

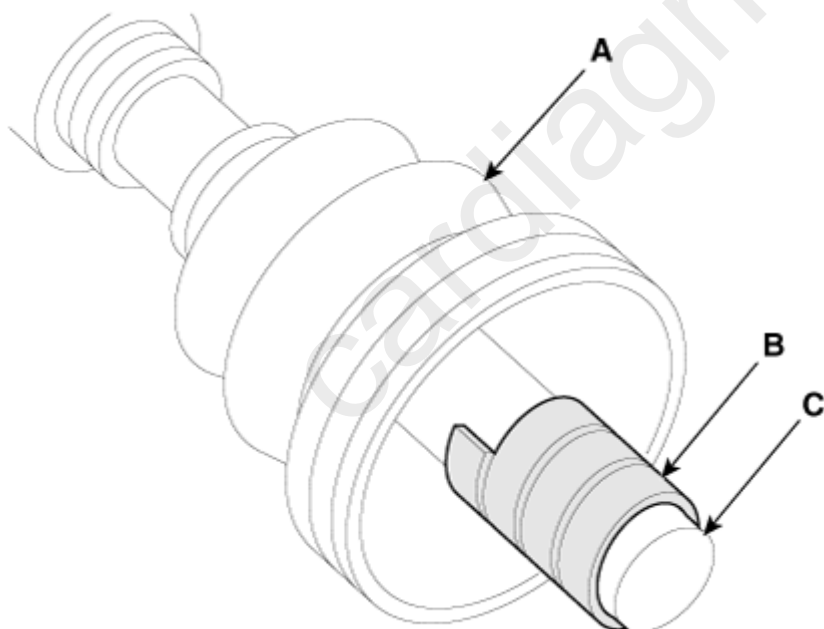

INSPECTION

1. Check the spider assembly for roller rotation, wear or corrosion.
2. Check the groove inside the joint case for wear or corrosion
3. Check the TJ boots for damage and deterioration.

INSTALLATION

1. Wrap tape around the driveshaft spline(TJ) to prevent damage to the boot.

English

2. Using the alignment marks (D) made during disassembly as a guide, install the spider assembly (A) and snap ring (B) on the driveshaft splines (C).

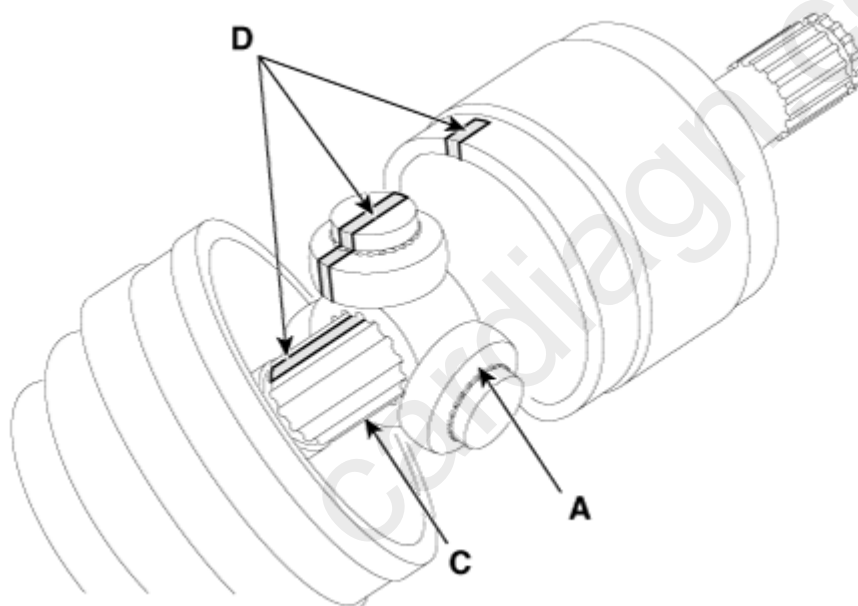
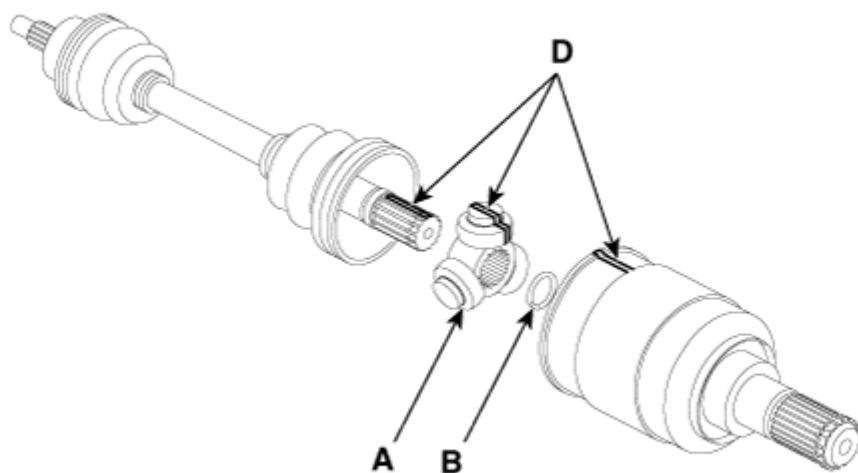

3. Add specified grease to the joint boot as much as it was wiped away at inspection.

4. Install the both boot band.

5. To control the air in the TJ boot, keep the specified distance between the boot bands when they are tightened.

Engine	Distance (L) mm (in.)	
	LH side	RH side
2.0 T-GDI THETA II	479.9 (18.8937)	463.3 (18.2402)
R 2.2	480.4 (18.9134)	464.0 (18.2677)
3.3 T-GDI LAMBDA II	479.9 (18.8937)	463.4 (18.2441)

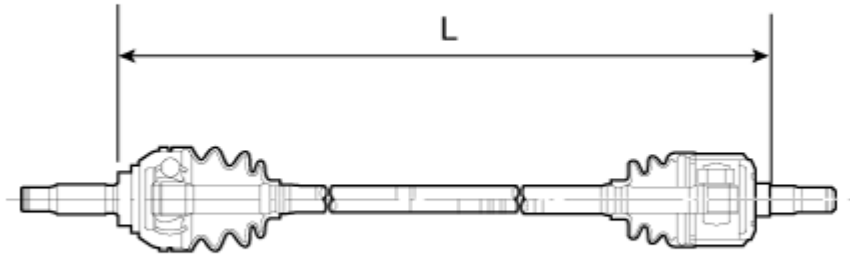

6. Using the SST(09495-3K000), secure the TJ boot bands.

Clearance (A): 2.0 mm (0.0787 in.) or less

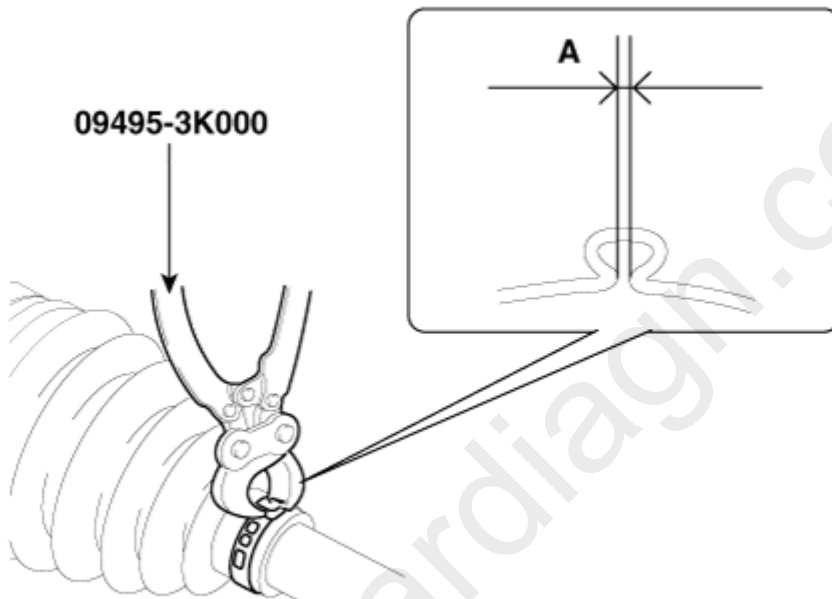

7. Install the Front Driveshaft.

(Refer to Driveshaft Assembly - "Front Driveshaft")

8. Check the front alignment.

(Refer to Suspension System - "Alignment")

*** Thanks for your cooperation for the more quality. Please surely rate this document before closing.**